

# Richland County, OH

## Summary 2024

Parcel Number 0372801705000  
 Location Address 2890 ALTA WEST RD  
 MANSFIELD OH 44903  
 Legal Description SE A 1.0 LT 7 PT  
 (Note: Not to be used on legal documents.)  
 Property Class R - RESIDENTIAL  
 Land Use (511) R - SINGLE FAMILY, O-9.99 AC  
 Neighborhood 03728000  
 Tax District (037) SPRNFLD TP ONTARIO  
 Acres 1  
 Sec/Twp/Rng 34-21-19  
 Township SPRINGFIELD  
 School District ONTARIO LSD  
 Municipality UNINCORPORATED  
 Topo ROLLING  
 Utilities WELL, SEPTIC  
 Roads PAVED  
 Traffic LIGHT



0372801705000 09/29/2021

[View Map](#)

## Owners

Owner  
 HUFFNAGLE TERRI L  
 Mailing Address  
 HUFFNAGLE TERRI L  
 4245 CHESTNUT AVE  
 OAKFORD PA 19053

Treasurer Code FORECLOSURE FEE

## Valuation

Assessed Year	2024	2023	2022	2021
Land Value	\$4,540.00	\$4,540.00	\$4,130.00	\$4,130.00
Building Value	\$11,790.00	\$11,790.00	\$8,740.00	\$8,740.00
<b>Total Value (Assessed 35%)</b>	<b>\$16,330.00</b>	<b>\$16,330.00</b>	<b>\$12,870.00</b>	<b>\$12,870.00</b>
Land Value	\$12,980.00	\$12,980.00	\$11,800.00	\$11,800.00
Building Value	\$33,690.00	\$33,690.00	\$24,970.00	\$24,970.00
CAUV Value	\$0.00	\$0.00	\$0.00	\$0.00
<b>Total Value (Appraised 100%)</b>	<b>\$46,670.00</b>	<b>\$46,670.00</b>	<b>\$36,770.00</b>	<b>\$36,770.00</b>

## Taxes Due

Tax Year (click for detail)	1st Half Due	2nd Half Due	Delinquent	Total Due
2024	\$0.00	\$0.00	\$27,437.71	\$27,437.71
2023	\$0.00	\$0.00	\$0.00	\$0.00
2022	\$0.00	\$0.00	\$0.00	\$0.00
2021	\$0.00	\$0.00	\$0.00	\$0.00
2020	\$0.00	\$0.00	\$0.00	\$0.00
2019	\$0.00	\$0.00	\$0.00	\$0.00
2018	\$0.00	\$0.00	\$0.00	\$0.00

## Land

Descr	P	LN	CD	Acres	Frontage	Depth	Base Size	Base Rate	Sq ft.	Incr / Descr	Land-Val
Homesite	A	1	1	1.0000	0	0	1.00	22.000	43,560	22000 / 22000	\$12,980

Total Acres:  
1.0000  
 Total Land-Value:  
\$12,980

## Residential Improvement Information

Card	1	Bathroom Remodeled	2
Stories	1	Kitchen Remodeled	2
Exterior Wall	AL/VINYL	Total Rooms	6
Style	RANCH	Bedrooms	3
Square Feet	1492	Full Baths	1
Basement	PART	Half Baths	0
Heating Fuel Type	OIL	Family Rooms	0
Physical Condition		Additional Fixtures	2
Attic	NONE	Total Fixtures	5
Year Built	1950	WBFP Stacks	1
Effective Year	0	Fireplace Openings	1
Year Remodeled	0	Prefab Fireplace	0

## Other Dwelling Features

Card	1	Finished Basement (L x W)	
Masonry Trim (L x W)		Finished Basement Area	0
Masonry Trim Area	0	Finished Basement Value	\$0
Masonry Trim Value	\$0	Basement Garage	\$0
Unfin Trim (L x W)	46 x 10	# Cars	0
Unfin Trim Area	460	Misc Desc 1	
Unfin Trim Value	(\$6,500)	Note 1	
Rec Room (L x W)		Note 2	
Rec Room Area	0	Condo Level	0
Rec Room Value	\$0	Condo Type	

**Additions**

Card 1

Line	Lower	First	Second	Third	Area	Value
0		Main Building			1032	0
1		10- 1SFR FRAME			460	30,900
2		12- EFP ENCL FRAME PORCH			483	27,100
3		13- FR GR FRAME GARAGE			264	7,400
4		33- MA_PT CONC/MAS PATIO	32- CANPY CANOPY		315	5,500

**Sales**

Date	Book	Page	Grantor	Grantee	Price	Instr Type	Sale Validity	Qualified
8/30/2012			CITIFINANCIAL INC	HUFFNAGLE TERRI L	\$16,000	SW	BANK RESALE	Unqualified
6/14/2012			HYLTON NANCY J	CITIFINANCIAL INC	\$23,334	SD	SHERIFF SALE	Unqualified
2/20/1992				HYLTON NANCY J	\$0		NOT VALIDATED	Unqualified

**Recent Sales in Area**

Sale date range:

From:  To:

Distance:

**Pay Property Taxes**

**Photos**



0372801705000 09/29/2021



037-28-017-05-000 06/08/2016



037-28-017-05-000 07/10/2013

**Sketches**

To magnify the Sketch, you may right click on the image to download or to open the image in a new tab. These options will then allow you to zoom in.

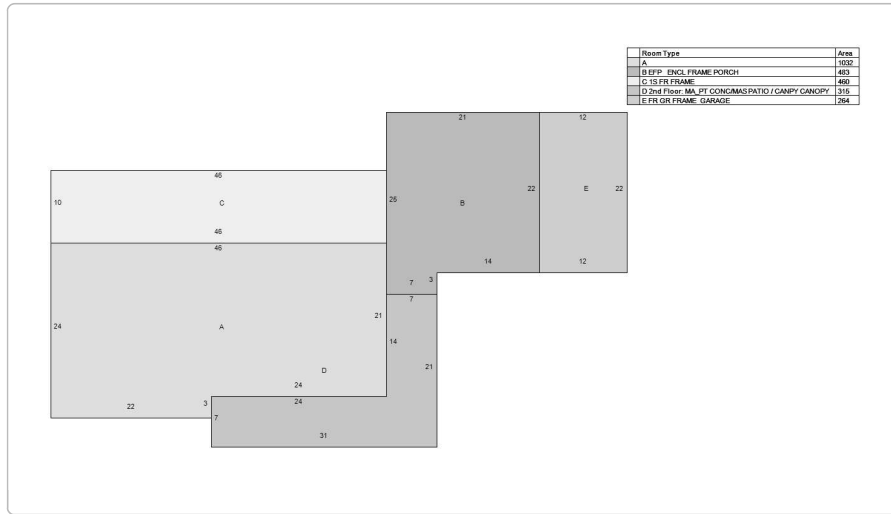

No data available for the following modules: Commercial Improvement Information, Interior/Exterior Information, Other Buildings & Yard Improvements, Other Features, Permits.

The information displayed on this map is taken from public records, and is intended to be used as a reference. Map information is believed to be accurate, but accuracy is not guaranteed. Richland County makes no warranties, express or implied, concerning the accuracy, completeness, or reliability of this information, and assumes no liability or any other legal responsibility for the information contained on this map. The map does not represent the official survey of the land.  
[User Privacy Policy](#) | [GDPR Privacy Notice](#)  
 Last Data Upload: 1/8/2025, 2:43:30 AM

Contact Us

